



St. Peters Road, St. Leonards-On-Sea TN37 6JG

Offers in excess of £450,000



Stunning FIVE BEDROOM family home ideally positioned just a short stroll from both the hub of St. Leonards On Sea and Hastings Town centre making it perfectly placed to enjoy LIFE BY THE SEA. There are a range of independent stores, eateries and two mainline railway stations within waking distance. Having undergone significant restoration throughout the accommodation here spans three storeys is PRESENTED TO AN EXCELLENT STANDARD. Approached via an ENCLOSED PORCH the ground floor offers a bright, BAY FRONTED LIVING SPACE which enjoys a front aspect. There here is a SEPARATE DINING ROOM with double doors leading out to the rear garden and a NEWLY FITTED KITCHEN which sits at the rear of the house with a SEPARATE UTILITY ROOM and handy downstairs cloakroom. On the first floor there are three double bedrooms along with the newly fitted, CONTEMPORARY FAMILY BATHROOM where there is a freestanding bath. The upper floor houses two further double bedrooms and a modern shower room. The enclosed rear garden is mainly laid to lawn with a seating area, shed and gated rear access. Enjoying GENEROUS PROPORTIONS and high end fittings which compliment the Victorian heritage, this CHAIN FREE family home is not to be missed.

GROUND FLOOR
725 sq.ft. (67.4 sq.m.) approx.

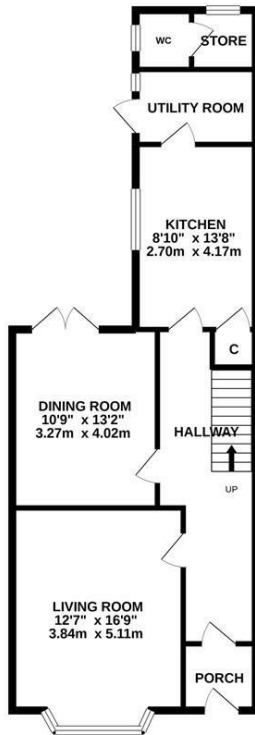

1ST FLOOR
721 sq.ft. (67.0 sq.m.) approx.

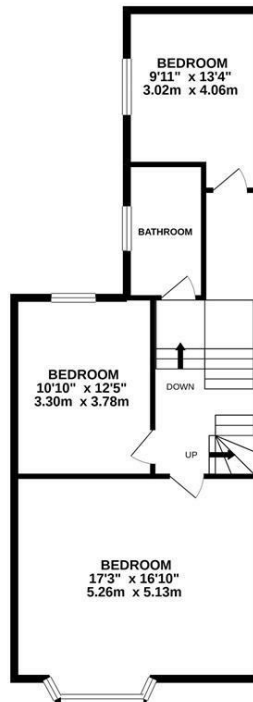

2ND FLOOR
471 sq.ft. (43.8 sq.m.) approx.

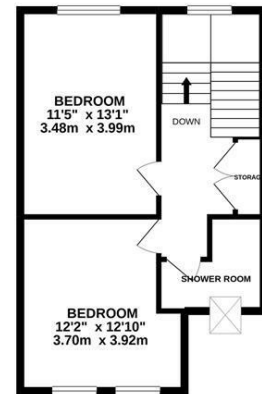

TOTAL FLOOR AREA: 1918 sq.ft. (178.1 sq.m.) approx.

Whilst every attempt has been made to ensure the accuracy of the floorplan contained here, measurements of doors, windows, rooms and any other items are approximate and no responsibility is taken for any error, omission or mis-statement. This plan is for illustrative purposes only and should be used as such by any prospective purchaser. The services, systems and appliances shown have not been tested and no guarantee as to their operability or efficiency can be given.
Made with Metropix ©2021

